

# Case Studies of New Development Space for Food Growing



# Brighton Planning Context

## Brighton and Hove Planning Advice Note 06, Food Growing and Development, 2011:

- “Recognise, safeguard, and encourage the role of allotments & garden plots within developments”
- **Goal:** allotment provision of at least 0.23 ha per 1000 residents, maximum 15 minutes walk
- **Benefits:** “improving the physical and mental health of residents, increasing bio-diversity in cities, reducing carbon emissions associated with long distance food distribution, and greening the urban landscape”

# One Brighton

- 172 apartment mixed-use development Completed 2010
- set out to be one of the greenest and most sustainable urban communities in Europe
- Rooftop **mini-allotments** & balconies with integrated planters suitable for growing food , '**edible landscaping**'



# Leeds Sustainable Food City



- Home
- About
- Projects
- Sites+Map
- Calendar
- Potting Shed
- Think Tank
- Advice
- Resources

Zoom in to where you are to find out what's happening near you. [Scroll below the map](#) for our 'Dating Service' | [No map?](#)

Zoom+pan here, or use mouse wheel and left-click+drag - Enter postcode to centre map - Use Search below right to find entries

## Parks containing Edible Beds (17 Entries)

Sites of (usually ornamental) food-growing beds planted and maintained by LCC Parks and Countryside.

NB Pin does not indicate precise location of bed. Please check with Parks on [parks@leeds.gov.uk](mailto:parks@leeds.gov.uk) or [0113 395 7400](tel:01133957400) before travelling

Local groups are encouraged to adopt these, and/or plant their own (in collaboration with Parks)

RIGHT-CLICK on any pin or shape then click 'More' to access the table or click on any T below  
Hover over any D for a description  
Click layers on and off below

### Member Layers

- ▼ 1 Green Space and Landscape (3)
  - Notes and Queries D I
  - Friends and Volunteers D I
  - Parks Forum Members D I
- ▼ 2 Food Growing (10)
  - Parks containing Edible Beds D I
  - Community Growing Projects D I
  - Council Allotments D I
  - Other Allotments D I
  - Potential New Allotments? D I
  - Possible New Food Projects D I
  - Landowner-friendly sites D I
  - Orchards + Forest Gardens D I
  - Resources (compost, tools etc) D I
  - Bee Hives D I
- ▼ 8 Leeds Edible Campus (2)
  - LEC Phase 1 D I
  - LEC Food Patches D I
- ▼ 9 Schools (1)
  - LESSN Champion Schools D I

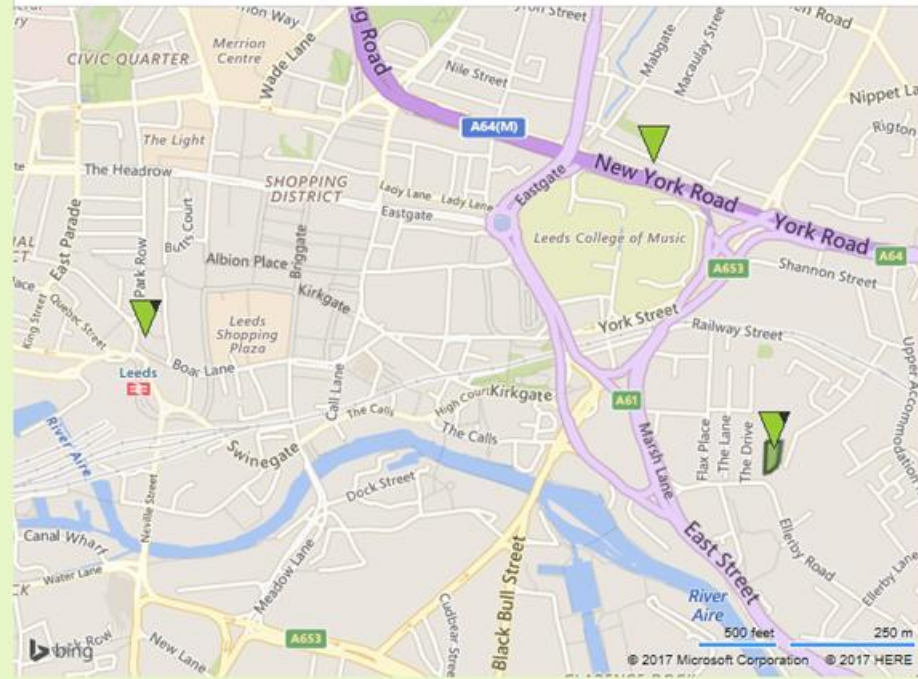

Map Layers Off Show Search

# Leeds Planning Context

- Core Strategy 2014
- Aire Valley Area Action Plan 2016/7
- make it easier for people to lead healthy lifestyles, with better access to fresh food shopping, the ability to grow their own food locally, and participate in recreational activities.



# Saxton Gardens

Before



After



# Site Plan

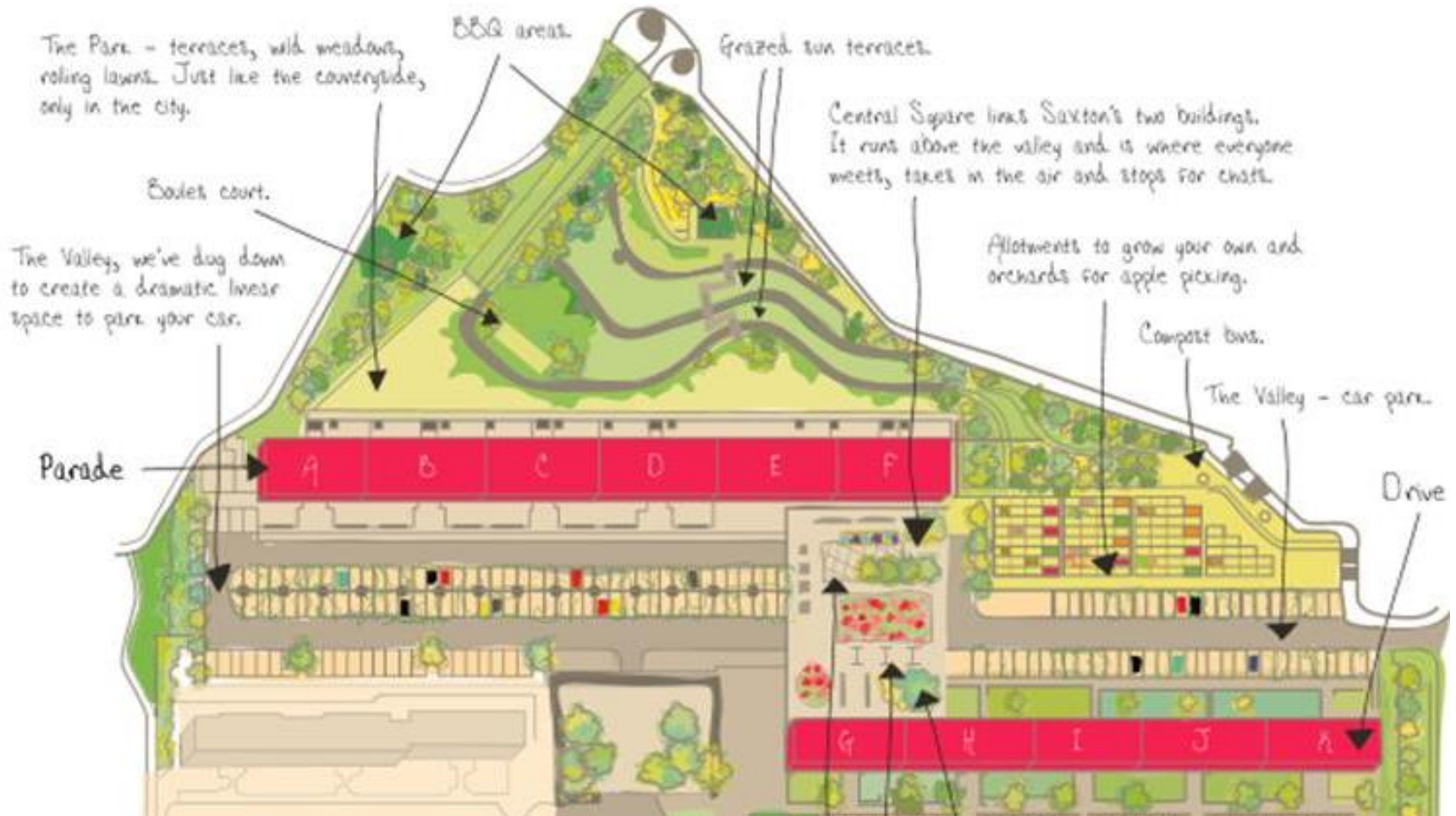

# Grow Your Own



Living Projects  
Saxton, Leeds  
from Living Projects



# Newham Planning Context

## Newham Local Plan – Detailed Sites and Policies Development Plan Document 2016

- Policy SC5 – Maximising Sustainable Design
  3. Development should take advantage of linked opportunities in sustainable design and minimise conflict between different strands, notably through:
    - d. the opportunity to integrate **food growing**, including consideration as a temporary use.

# Rathbone Market Canning Town

- Area formerly 1960s residential blocks, shops & a failing street market
- Development of contemporary apartments now boasts **communal gardens and allotments.**
- Mixed-use development on 5.5 acres with 652 new homes.



# Waltham Forest Planning Context

## Waltham Forest Local Plan - Core Strategy, 2012

- Policy CS5 – Enhancing Green Infrastructure and Biodiversity  
E “ensuring the adequate provision and efficient use of allotments and other spaces on which to **grow food** and plants”
- 8.20 – “Allotments, community gardens, and urban farms are a useful resource for delivering a range of benefits including providing a healthy and sustainable food resource and fostering opportunities for gentle exercise.”

## Development Management Policies , 2013

- Policy DM12 “The Council will expect development proposals to contribute to the supply, quality and accessibility of private and communal spaces on which **to grow food** and flowers”

# Walthamstow Stadium

- East London, borough of Waltham Forest
- Demolition of greyhound racing track besides historic sign
- 294 new homes of mixed form and tenure
- Community facilities including nursery, café, sports centre, and **new pocket allotments**



# Lessons Learned

- Planning policy is a statement of council priorities to guide new development; don't assume individual policies will be applied in all cases. They are not regulatory mechanisms to be “implemented”.
  - To create new food growing spaces, use planning policies to show support for your work, combining with other strategies
- Not all food growing spaces need planning permission
- Some planners, instead of recommending food growing space in new developments, recommend flexible green space that can become allotments, play area, outdoor seating etc, according to residents' wishes
- Developers are trending towards “place making” and “community infrastructure” in new developments – food growing space can help them meet that goal
- Policy is the start of the journey, engagement, facilitation and ongoing management are key.

# Webinar Key Messages

- **Sustainable Food Cities**  
Think: what do you want your place to look like?
- **Developers**  
Improve social & environmental attractiveness of development
- **Councils**  
Planning for a sustainable food system meets many strategic objectives



# Time for Questions & Discussions

**Post your questions in the chat box**

Do you have any good examples of new developments to share?

What does a sustainable food city will look like?

**For help with local plan making see our planning pages at**

**<https://www.sustainweb.org/planning/>**

**Sign up for our newsletter**

Email [gillian@sustainweb.org](mailto:gillian@sustainweb.org)